

# RIVERVIEW DRIVE

# Highway 95 Building

- 35,000 sq. ft. upstairs and downstairs
- 20' x 60' minimum suites
- Combine suites for up to 30,000 square feet

**For more information, contact:**

Richard Biegel  
 928-704-0460 (office)  
 702-513-2703 (cell)  
 richard@coloradoplace.com



2580 Highway 95, Suite 211 • Bullhead City, AZ 86442  
 (Formerly Upton Plaza)

**2580 HIGHWAY 95**

**FIRST STORY** →

**SECOND STORY** →

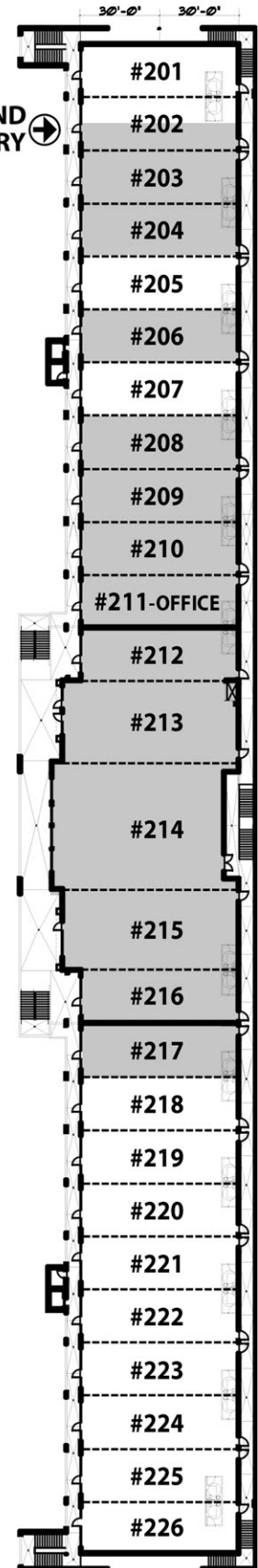
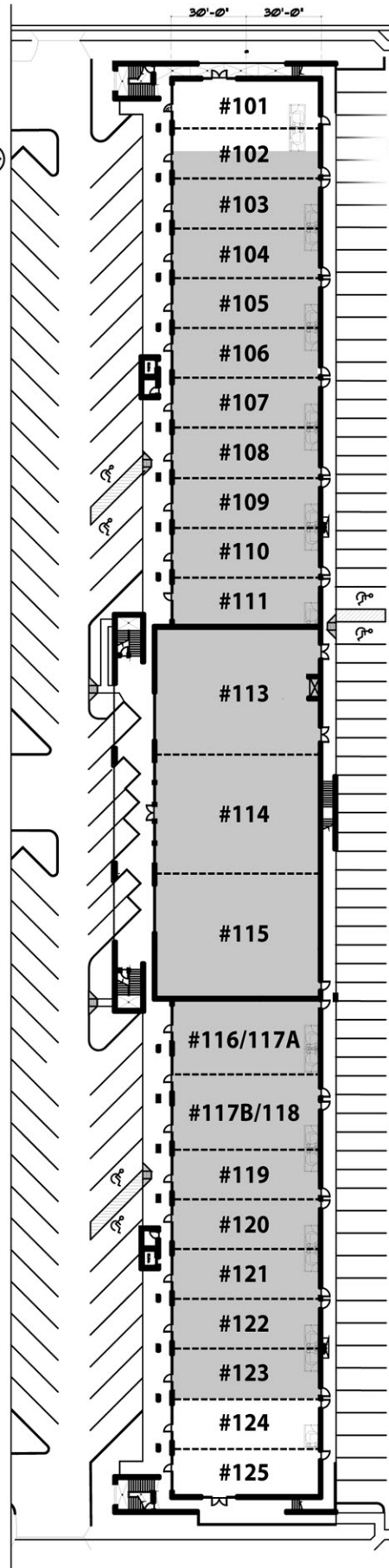

□ = AVAILABLE    ■ = OCCUPIED

# HAVASUPAI DRIVE